



POWERWAVE
ACCESSORIES

XBOX DUAL CHARGING STAND

INSTRUCTIONS

The Powerwave Xbox Dual Charging Stand is your one charging solution for all* Xbox One and Xbox Series X|S controllers. Charge your controllers in between gaming sessions with this convenient USB powered stand which can be plugged into any available USB-A port on your console. The Powerwave Xbox Dual Charging Stand comes with 2 choices of battery covers for use with Xbox One or Xbox Series X|S controllers.

HOW TO USE:

1. Plug in the supplied USB cable into a USB port or compatible power adapter.

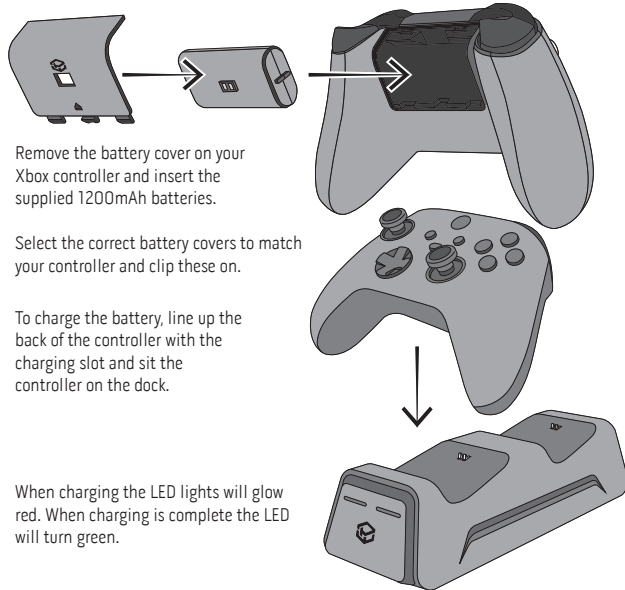

2. Remove the battery cover on your Xbox controller and insert the supplied 1200mAh batteries.
3. Select the correct battery covers to match your controller and clip these on.
4. To charge the battery, line up the back of the controller with the charging slot and sit the controller on the dock.
5. When charging the LED lights will glow red. When charging is complete the LED will turn green.

TECHNICAL SPECIFICATIONS:

- Input voltage: 5V
- Battery capacity: 1200mAh
- Output voltage: 3V±5%
- Charging current: 400mA
- Battery charging cut off voltage: >2.91V
- Temperature protection: if the internal temperature of the battery is >52°C it will stop charging.
- The charging stand will automatically stop charging after 5 hours.

PRODUCT CARE:

- If the product gets wet or damaged, stop using immediately.
- Keep clean by wiping with a soft dry cloth. Do not use water, alcohol or detergent.
- Keep out of direct sunlight.
- Do not attempt to modify or repair.
- Do not apply strong impact or weight.
- Keep away from children.