



POWERWAVE
ACCESSORIES

4 PORT USB HUB

INSTRUCTIONS



Contents

PRODUCT OVERVIEW	2
PRODUCT LAYOUT	2
INSTRUCTIONS FOR USE	3
PRODUCT SPECIFICATIONS	4
PRODUCT CARE AND SAFETY.....	4

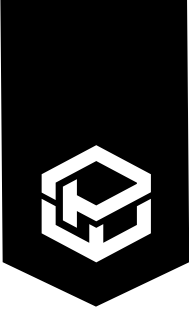

4 PORT USB HUB

INSTRUCTIONS

Product Overview

Expand one USB Port into four with the Powerwave 4 Port USB Hub. Supporting USB 3.0 super speeds of up to 5Gbps on 3.0 compatible devices, you'll never need to swap or unplug your accessories again. Control each port with its own individual power switch, the Powerwave 4 Port USB Hub also features individual LED's to show which devices are powered on.

Product Layout

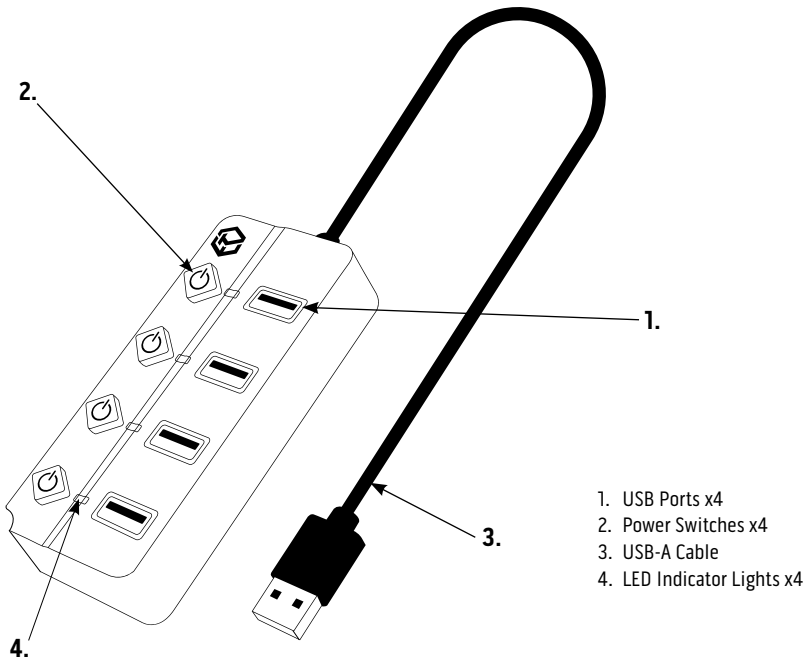

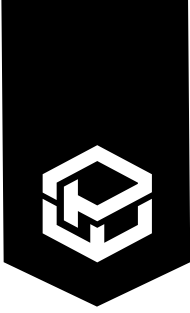

4 PORT USB HUB

INSTRUCTIONS

Instructions For Use

- Plug the USB-A cable into an available USB port.
- Plug in USB peripherals, using the individual power switches to control each USB port. The blue light indicates that the USB port is on and active.
- Compatible with both USB 2.0 & USB 3.0 devices, however will only achieve 3.0 performance on 3.0 devices if the USB-A cable is inserted into a USB 3.0 port.

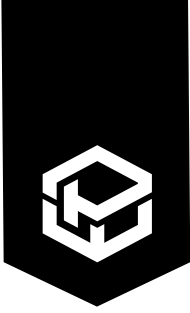

4 PORT USB HUB

INSTRUCTIONS

Product Specifications

Specifications	
Compatibility	USB 3.0 & USB 2.0
Driver Support	Windows 2k/XP/Vista/Win7/Linux/MAC os 10.0+
LED Indication	LED Blue = Power On, Absent = Power off
Maximum Data Transfer Rate	USB3.0:5Gbps/USB2.0: 480Mbps

Product Care and Safety

- Keep your user manual for future reference.
- Use this device solely for its intended purposes.
- For indoor use only.
- Keep away from hot surfaces and naked flames.
- When not in use, store in a cool, dry environment away from direct sunlight.
- Do not apply force or put heavy objects on the product.
- If the product is damaged, broken or immersed in water, stop use immediately.
- Do not attempt to repair, modify or disassemble.
- Clean with a soft, dry cloth to prevent dirt build-up. Do not use chemical solvents, detergents or alcohol.
- Keep out of reach of small children.