



POWERWAVE
ACCESSORIES

SWITCH WIRELESS CONTROLLER

INSTRUCTIONS





POWERWAVE
ACCESSORIES

SWITCH WIRELESS CONTROLLER

INSTRUCTIONS

Product Overview

This is a Bluetooth wireless controller which can be used with Nintendo Switch™ Consoles. Features include one-key awakening for consoles, adjustable motor vibration, manual turbo and automatic turbo. It can also be used on PC host machine (realise PCx input functions), on Android platforms (realise Android Gamepad mode) and on IOS 13 (MFI games).

Controller Layout

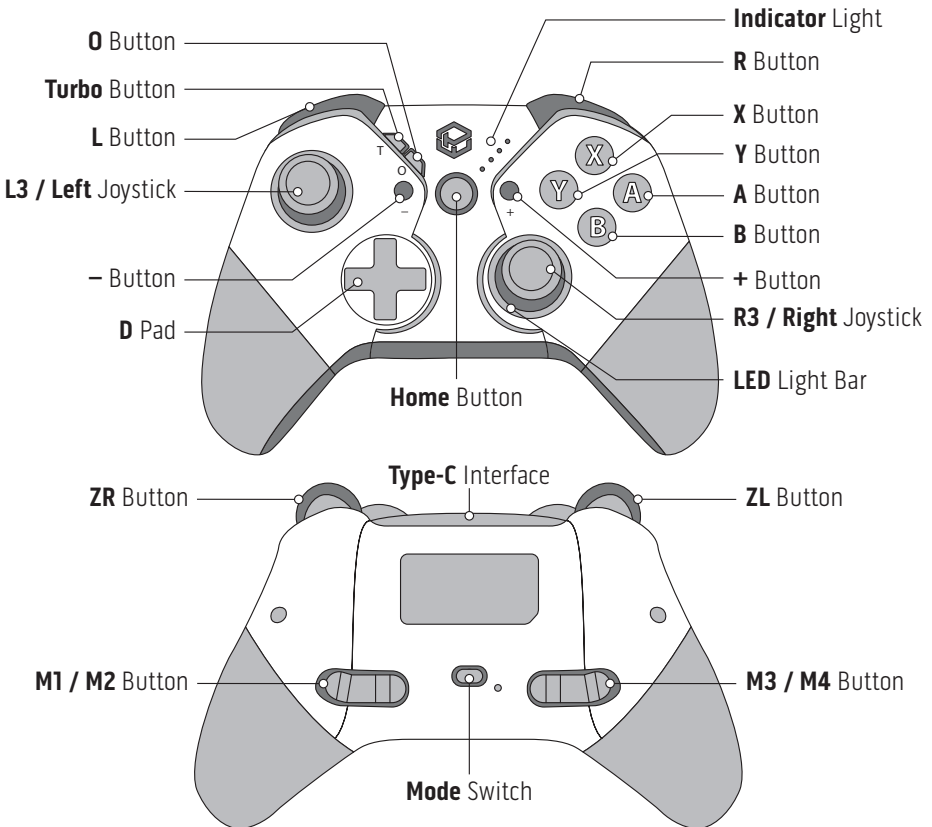



POWERWAVE
ACCESSORIES

SWITCH WIRELESS CONTROLLER

INSTRUCTIONS

Operation Guide

1. Descriptions of Modes and Connection

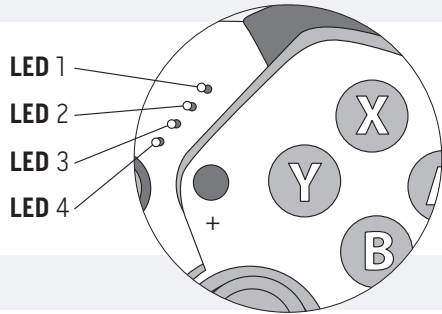

Wireless:

Nintendo Switch™:

Press and hold HOME button for 5 seconds until the indicator LED lights flash quickly to enter the Bluetooth search mode. After it is successfully connected, corresponding channel indicators will remain on.

Note: After the controller enters synchronise mode, it will sleep automatically if it is not successfully synchronised within 2.5 minutes.

1. Select 'Controllers' on your Nintendo Switch™ homepage.

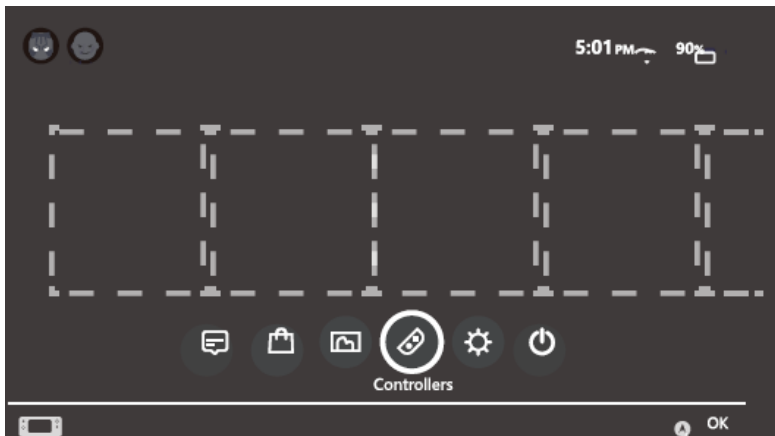



POWERWAVE
ACCESSORIES

SWITCH WIRELESS CONTROLLER

INSTRUCTIONS

2. Select 'Change Grip/Order'.

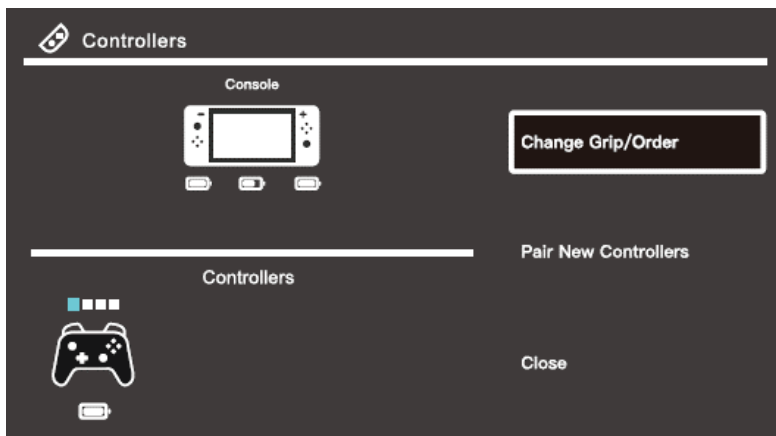

3. Follow instructions on screen to complete connection.

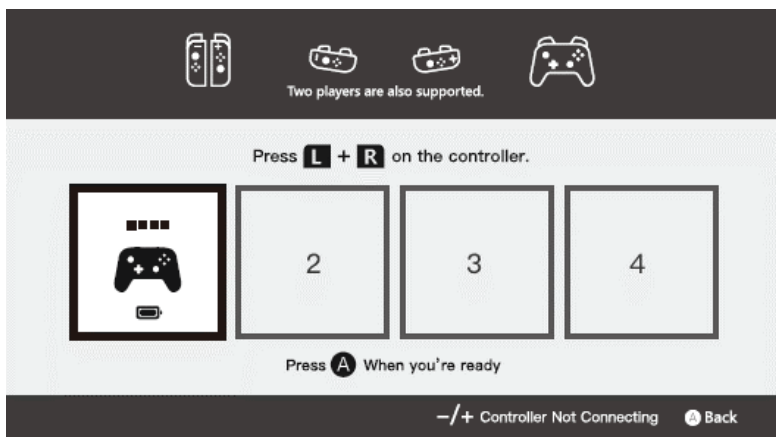



POWERWAVE
ACCESSORIES

SWITCH WIRELESS CONTROLLER

INSTRUCTIONS

Android:

Press and hold HOME and X buttons for 5 seconds and the LED will flash quickly to enter the Bluetooth search mode. After it is successfully connected, LED1 will be always on.

IOS 13:

Press and hold HOME and A buttons for 5 seconds and LED2+LED3 will flash quickly; after it is successfully connected, LED2+LED3 will be always on. It can also be used to play MFI games.

PC:

Press and hold HOME and X buttons for 5 seconds and the LED1 will flash quickly to enter the Bluetooth search mode. After it is successfully connected, LED1 will be always on.

Wired:

Nintendo Switch™:

Connect the controller to the Nintendo Switch™ Console dock using a USB cable. After connection, corresponding LED lights on the controller will be always on.

PC:

Connect the controller to the computer using a USB cable. The computer will automatically detect and connect to the controller. The controller LED3 will be always on after connection. (Note: The default mode of the controller on PC is X-INPUT mode).

2. Reconnect and Wake-Up

Reconnect Controller: When the controller is in sleep state, short press any button and the LED1-LED4 will flash. Now the controller will automatically connect back to the console.

Wake-Up Console: When the console is in sleep state, short press the HOME button and the LED1-LED4 will flash. The console will wake up and the controller will automatically reconnect.



POWERWAVE
ACCESSORIES

SWITCH WIRELESS CONTROLLER

INSTRUCTIONS

3. Dormant State and Disconnection

If the console screen is off, the controller will automatically enter the dormant state. If no button is pressed within 5 minutes, the controller will enter the dormant state automatically (the sensor will also not work).

In the wireless connection state, you can press HOME Button for 5 seconds to disconnect it from the console.

4. Charging Indication

While Controller is off: If the controller is charging, LED1-LED4 will flash slowly. If the controller is fully charged the LED light will be off.

While Controller is on: If the controller is charging, the current channel indicator will flash (slow flashing). The current channel indicator will be always on when the controller is fully charged.

5. Low Voltage Alarm

If the battery voltage is lower than $3.55V \pm 0.1V$, the current channel light will flash quickly to show the low voltage. When the battery voltage is lower than $3.45V \pm 0.1V$, the controller will enter the dormant state automatically. Low voltage alarm: The current channel indicator flashes (fast flash).

6. Turbo Function

Manual Turbo Function: Press and hold T button and press one or several buttons (A/B/X/Y/L/R/ZL/ZR) you would like to activate the turbo function on. Then release T button.

*Manual Turbo Function means an input can activate continuously when a button is held down.

Automatic Turbo Function: After Manual Turbo Function has been activated on a button, press and hold T button again and press another button a second time to activate automatic turbo function.

*Automatic Turbo Function means an input will activate continuously when a button is pressed a single time.



SWITCH WIRELESS CONTROLLER

INSTRUCTIONS

Clear Single Turbo Setting:

Press and hold T button and press another button a third time to clear turbo settings from that button.

Clear All Turbo Settings:

Press and hold T button for 5 seconds and then press the - button to clear all Turbo functions.

7.RGB Dazzling Light

When the controller is turned on, the dazzling light will be set by default and the 8 colours of dark blue, red, green, yellow, light blue, orange, purple and pink will be set circularly.

Press T Button 3 times to turn the RGB dazzling lights off or on.

8.Motor Vibration Speed Adjustment (for Nintendo Switch™ Only)

When the controller is connected, press and hold L, R, ZL and ZR buttons simultaneously to adjust the motor intensity (the controller will vibrate once each time you adjust it). The motor vibration can be adjusted to three levels; 'Strong', 'Medium' and 'Weak'. Each time the controller is connected to a device for the first time 'Medium' will be the default level; followed by 'Strong' and 'Weak'.

9.M Button Function Programming

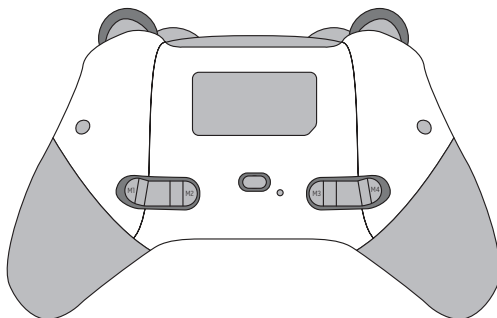

M button =
M1 M2 M3 M4

Buttons that can be programmed include
↑ / ↓ / ← / → / A / B / X / Y / L / R / ZL / ZR / L3 / R3



POWERWAVE
ACCESSORIES

SWITCH WIRELESS CONTROLLER

INSTRUCTIONS

Cancel M Button Functions:

Turn the Mode Switch at the back of the console to the middle to turn off M Button function.

Normal Mode:

Shift the Mode Switch to the left (towards M2).

M1 for X, M2 for Y, M3 for B, M4 for A. These functions cannot be adjusted.

Programming Mode:

Shift the Mode Switch to the right (towards M3).

M1 for ZR, M2 for R, M3 for L, and M4 for ZL. These functions can be adjusted following the below step:

Setting Method:

Press and hold the M button you would like to adjust and hold the + button, the LED indicating light will flash quickly. Then, release and press any one or several buttons to be set (↑/↓/←/→/A/B/X/Y/L/R/ZL/ZR/L3/R3) the LED indicating light will flash once for each input registered. Press the M button again to save the setting.

For example; press and hold the M1 and + buttons to begin programming (the indicator flashes once). Press the A button and then press the M1 button again. Now the M1 button corresponds to A button function.

Clear M button function by holding the M1, M4 and - buttons simultaneously for 4 seconds. The LED indicator light will flash once to indicate setting have been restored to default values.

10.Reset Controller Hardware

To reset the controller hardware, hold down the power button for 20 seconds.

The controller will first turn off, then the LED indicator lights will start to flash, then begin to flash quickly. Once the LED indicator lights are flashing quickly the controller has entered Bluetooth pairing mode and is ready to connect to a device.



SWITCH WIRELESS CONTROLLER

INSTRUCTIONS

Electrical Parameters

Dormant Current:	Less than 27uA
Pairing Current:	30~60mA
Working Voltage:	3.7V
Current:	25mA-150mA
Input Voltage:	DC4.5~5.5V
Input Current:	600mA
Bluetooth Version:	2.1+EDR
Cable Length:	1.5m

Product Care & Safety

- Keep your user manual for future reference.
- Use this device solely for its intended purposes. For indoor use only.
- Keep away from hot surfaces and naked flames.
- When not in use, store in a cool, dry environment away from direct sunlight.
- Do not apply force or put heavy objects on the controller.
- If the controller is damaged, broken or immersed in water, stop use immediately.
- Persons who have an injury or disorder involving their fingers, hands or arms should not use the vibration function.
- Do not attempt to repair, modify or disassemble the controller.
- Clean the controller with a soft, damp cloth to prevent dirt build-up.
Do not use chemical solvents, detergents or alcohol.
- Keep out of reach of small children.